



**[d]arc awards**  
CELEBRATING THE BEST IN LIGHTING DESIGN  
**ENTRY 2020**



## French Chic

Designed by Agence ON and Alain Gilles, a new avenue of light poles from Technilum now line the La Croisette promenade in Cannes, bringing a stylish functionality to the space.

**C**hic tailor-made lighting structures have been installed along the world-famous La Croisette promenade in Cannes, France. Imagined by lighting designer Vincent Thiesson of Agence ON, and Belgian designer Alain Gilles, the structures were developed and manufactured by French company Technilum, and now mark the entryway to Cannes' beachfront. Created to enhance the public realm, this elegant lighting furniture is also integrated with 10 additional smart features, including dynamic and textured lighting, alongside signage, CCTV, speakers, menu-holders and mailboxes.

Agence ON designed a stylish lighting scheme, intended to create a strong identity along the entire bay of Cannes. Like the architecture of the new beach restaurants on La Croisette, the lighting structures are modernist inspired, while showcasing streamlined Art Deco details to echo the façades of some of the promenade's famous hotels. At nightfall, the LEDs placed on the mast draw a dotted line, like a topstitch. These light points create a visual identity between all of the beach entrances along the promenade and highlight the particular curve of Cannes' bay. Distinctive dynamic light scenographies can be scheduled to accompany the different events that the city celebrates, such as Bastille Day, Cannes Festival, St. Patrick's Day and Christmas.

In addition, each beach entrance is illuminated with additional soft, textured lighting that seeks to evoke the sun's reflection on the sea.

For this, special projectors equipped with LED and focusing lenses have been developed by Agence ON, Alain Gilles and Technilum. Beyond offering a distinctive and revealing lighting, the wish of the City of Cannes was to take advantage of the masts to provide multiple functions. By incorporating numerous technologies into one pole, the planners were able to drastically limit the amount of furniture needed along the promenade, which has in turn helped to reduce public space congestion.

The 6.5-metre poles are tailor-made out of aluminium, meaning that they have a lower carbon footprint and are indefinitely recyclable, while being entirely weld-free also avoids any risk of corrosion. Comprised of 230 parts, all of them developed, manufactured and carefully assembled in Technilum's factory in the south of France, the lighting structures have benefitted from the skills of a multidisciplinary and experience team, guaranteeing an impactful result that meets the top-level requirements of the City of Cannes. Special attention has been given to create a distinctive design that offers the right proportions, with all required functions harmoniously integrated within the pole itself. The simplicity of the shapes and the quality and thickness of the material give the masts an opulent and timeless look – perfectly in keeping with their luxurious surrounds. ■

[www.technilum.com](http://www.technilum.com)

# Spring Sales

A look at some of the latest products and innovations to hit the market from across the lighting industry.



## **Arcos III** **Zumtobel**

Zumtobel's Arcos III is the third generation in the Arcos family. Developed for art galleries, museums, and the constantly changing requirements of exhibition spaces, Arcos III is a highly flexible lighting solution that brings artworks and exhibits to life using a highly innovative and intuitive zoom focus lens. Through the use of tunableWhite technology, Arcos III provides high colour rendering  $Ra > 96$  for stable white and a low colour shift (MacAdam2) enabling exhibits to be seen in the best possible light.

[www.zumtobel.com](http://www.zumtobel.com)

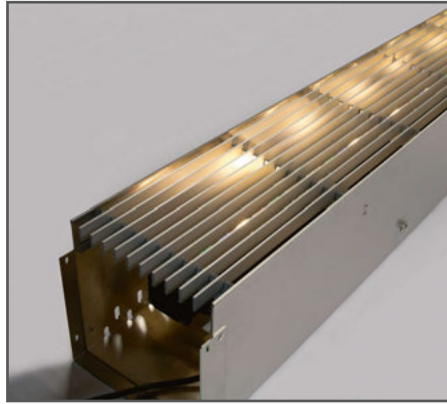

## **LED-Drainlights** **ADO Lights**

The LED-Drainlights with grating cover is a forward-looking solution, connecting aesthetic aspirations and practical requirements. Suitable for exterior and interior applications, it combines stainless steel drainage channels with an impressive LED illumination for buildings. Beautiful and useful, it allows rainwater to be reliably drained away through stainless steel draining channels, while the integrated LED illumination, which has an angle that can be individually determined, works whatever the weather.

[www.ado-lights.com](http://www.ado-lights.com)



## **Protozoa** **Stoane Lighting**

Stoane Lighting's tiniest spotlight is no taller than a Lego figure and is ideal for extremely discreet, close work such as museum showcases and jewellery retail lighting. As well as the surface mounted version, there is a height adjustable stick mounted version, two recessed types and also a single, double or triple LV track mounted version too. If needed it can be adapted for bespoke applications too. The whole family uses the same adjustable head with a zoomable lens, offering a generous  $13^\circ - 60^\circ$  beam range.

[www.stoanelighting.com](http://www.stoanelighting.com)



## **Sidu LED** **Ansell**

The Sidu LED pendant is an aluminium bi-directional suspended pendant with a black polycarbonate micro reflector design, which helps achieve  $UGR < 6$ . Compatible with the OCTO connected solution, offering tailored lighting to only illuminate desks that may be occupied, dimming for customised light levels, or pairing with smart sensors.

[www.anselluk.com](http://www.anselluk.com)

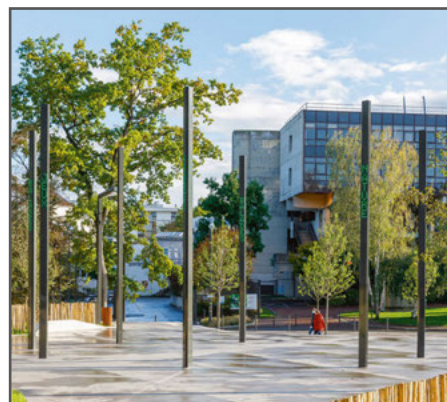

## **Jeny** **Technilum**

Singular in its style and applications, Jeny has a triangular shape profile and is equipped with three technical grooves that facilitate accessorisation. In tribute to Jenny Holzer, innovative artist in word expression, Jeny can be coupled with "LittleWords" from Technilum: an integrated LED screen allowing the interactive diffusion of messages or animations thanks to a dedicated application.

[www.technilum.com](http://www.technilum.com)



## **Outdoor Link System** **Acclaim Lighting**

The IP67-rated Outdoor Link System quickly and easily links Acclaim Lighting's Dyna Drum and Dyna Accent series fixtures, while eliminating excess hardware for lighting projects. The system allows the linking of up to 32 fixtures from a single power source without the need for a connection point at every unit. The system includes T junction, link cable, feed cable and end cap connection points, and performs in temperatures from  $-40^\circ\text{C}$  to  $80^\circ\text{C}$ .

[www.acclaimlighting.com](http://www.acclaimlighting.com)